



* GROUND FLOOR * SEA VIEWS FROM LOUNGE AND KITCHEN * RESIDENTS PARKING * NO ONWARD CHAIN * Occupying a prime position along Westcliff Seafront, this ground floor apartment offers effortless access with its level approach and proximity to the main entrance—ideal for ease of living and step-free convenience.

The apartment enjoys delightful views over the development's impeccably maintained communal gardens and offers glimpses of the sea from both the lounge/diner and kitchen, creating a tranquil and picturesque living environment.

Homecove House provides excellent peace of mind with a secure entry phone system, 24-hour emergency pull cord support connected to Carline, and the reassurance of an on-site full-time House Manager.

The property has been recently updated, featuring newly fitted double-glazed windows, fresh carpeting, and tasteful redecoration throughout - ready for immediate occupation.

Residents benefit from a welcoming and sociable atmosphere, with a strong sense of community and a regular calendar of events and activities. Communal facilities include a spacious residents' lounge, a well-equipped kitchen, laundry room, and beautifully landscaped gardens.

Leasehold: 59 year lease(approx.) // Service charge: £4,800pa(approx.) // Ground rent: £443pa(approx.)
Council Tax Band: C

- No onward chain
- Ample residents parking
- Spacious lounge with sea views
- Large bedroom with fitted wardrobes
- Communal gardens overlooking the seafront
- On Westcliff Seafront and seconds from Westcliff Station
- Newly fitted double-glazed windows and carpet
- Separate kitchen
- Convenient shower room
- Secure entry phone system, emergency pull cord support, and a full-time House Manager

Holland Road

Westcliff-on-Sea

£85,000

Offers In The Region Of



Holland Road



Frontage/Parking

Ample residents parking, secure entry phone system, front desk, a lift to access all floors, and a communal hallway leading to:

Entrance Hallway

Offers easy access to all rooms while thoughtfully separating the living and entertaining areas from the private bedroom space, ensuring both functionality and privacy.

Lounge

13'0" x 11'8"

Newly fitted UPVC double glazed windows with sea views, electric heater, storage cupboard, cornicing, skirting, and new carpet.

Kitchen

7'4" x 5'7"

Newly fitted UPVC double glazed window with sea views, shaker style kitchen units both wall mounted and base level, kitchen comprised of; space for fridge/freezer, stainless steel 1.5 sink with drainer and chrome mixer tap, four ring electric cooker, integrated extractor fan, space for dishwasher, tiled splashback, tiled flooring

Shower Room

16'3" x 8'8"

Newly fitted UPVC double glazed window with sea views, electric heater, bespoke fitted wardrobes, cornicing, skirting, new carpet

Bathroom

6'9" x 5'6"

Extractor fan, chrome towel rail, vanity unit with wash basin in chrome mixer tap, WC, corner shower, cornicing, ceiling to floor tiles, wood effect laminate flooring.

Agent Notes:

Leasehold: 59 year lease(approx.) // Service charge: £4,800pa(approx.) // Ground rent: £443pa(approx.)
Council Tax Band: C



Floor Plan

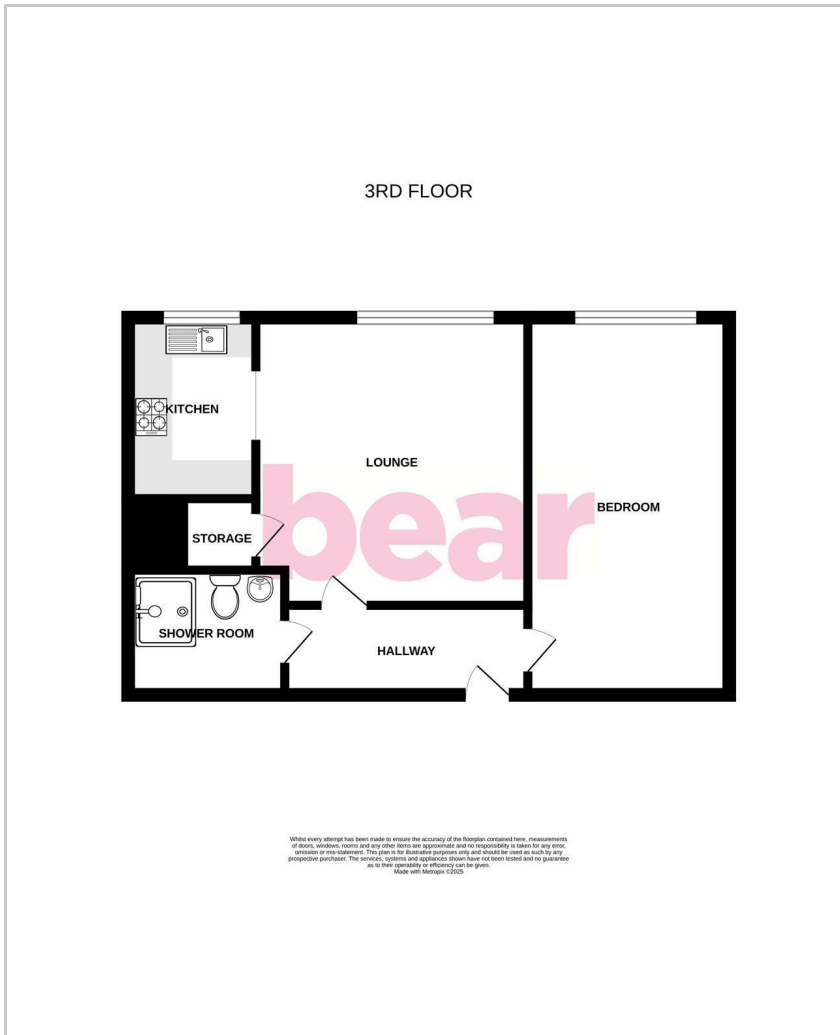

Area Map

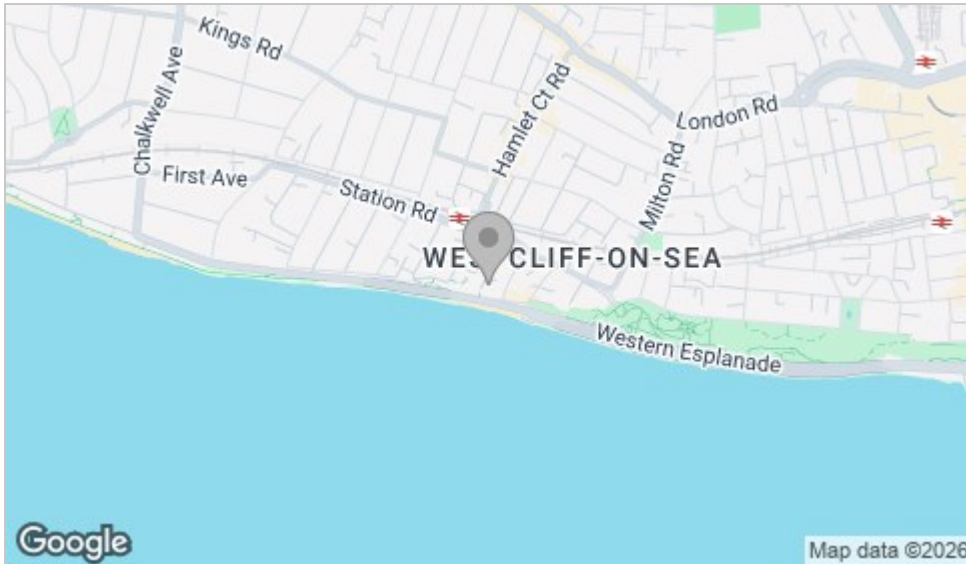

Viewing

Please contact our Leigh-on-Sea Office on 01702 887 496 if you wish to arrange a viewing appointment for this property or require further information.

These particulars, whilst believed to be accurate are set out as a general outline only for guidance and do not constitute any part of an offer or contract. Intending purchasers should not rely on them as statements of representation of fact, but must satisfy themselves by inspection or otherwise as to their accuracy. No person in this firm's employment has the authority to make or give any representation or warranty in respect of the property.

1336 London Road, Leigh-on-Sea, Essex, SS9 2UH

Office: 01702 887 496 los@bearestateagents.co.uk <http://www.bearestateagents.co.uk/>

Energy Efficiency Graph

